



LAVORI DI "INTERVENTO DI MIGLIORAMENTO DELLA
SICUREZZA ALLE INTERSEZIONI STRADALI DI
VISIBILITA' E DI ILLUMINAZIONE IN ALCUNE
STRADE DEL TERRITORIO COMUNALE

Scala 1/100/50
DIC. 2012

PROGETTISTA: A.T.P.
Il Capogruppo: dott. ing. S. Silvestri

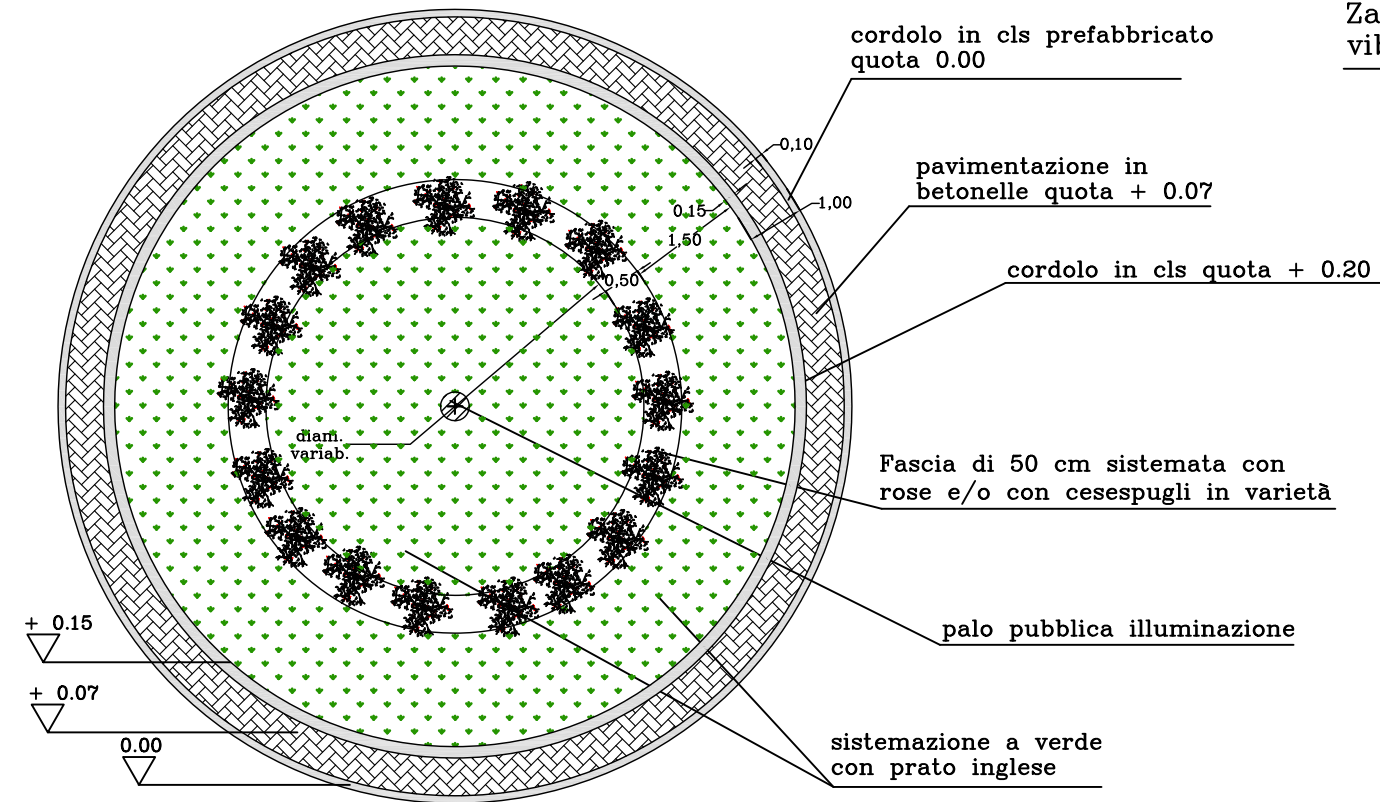

Diagram illustrating the cross-section of a roadside infrastructure detail, showing the following components and labels:

- palo pubblica illuminazione**: Public lighting pole.
- sistemazione a verde con prato inglese**: Greening system with English lawn.
- Fascia di 50 cm sistemata con rose e/o con cespugli in varietà**: 50 cm strip systematized with roses and/or various shrubs.
- pavimentazione in betonelle**: Paving stones.
- massetto di sottofondazione in sabbia e cemento H= 15 cm**: 15 cm sub-base of sand and cement.
- cordolo in conglomerato cementizio armato**: Reinforced concrete curb.
- cordolo in cls quota + 0.15**: Concrete curb at elevation +0.15.
- terreno vegetale**: Vegetated area.
- sede stradale + 0.00**: Roadway at elevation +0.00.
- strato drenante in misto**: Mixed drainage layer.
- getto in conglomerato cementizio**: Concrete cast.
- diam. variabile**: Variable diameter.
- P.A.S.**: Public Area Sign.
- 1:10**: Scale indicator.

Technical drawing of a road cross-section showing a 3.00m wide pedestrian area with yellow and white stripes, flanked by 0.20m wide sidewalks. The drawing includes elevations, material specifications, and a section line A-A.

Dimensions and Elevations:

- Top sidewalk width: 0.20
- Top sidewalk elevation: +0.15
- Top of road surface elevation: 0.00
- Top of yellow stripe elevation: +0.15
- Top of white stripe elevation: +0.07
- Top of yellow stripe elevation: +0.15
- Top of white stripe elevation: +0.15
- Top of yellow stripe elevation: +0.07
- Top of white stripe elevation: 0.00
- Bottom sidewalk elevation: +0.15
- Bottom sidewalk width: 0.20
- Bottom of road surface elevation: 0.00

Materials and Specifications:

- Zanella in cls. vibrato 40x10
- MARCIAPIEDE
- Griglia di progetto
- Striscie pedonali di colore giallo
- Striscie pedonali di colore bianco
- Striscie pedonali di colore giallo
- Cordolo in cls
- Zanella in cls. vibrato 40x10

Section Line A-A:

The section line A-A is indicated by a dashed line with arrows at both ends, passing through the center of the road surface.

Technical drawing of a road cross-section. The road is 10.00m wide with 2.00m shoulders. The subgrade is 0.15m high in the center and 0.07m high on the shoulders. The road surface is 0.00m high at the edges. The drawing includes a stone layer and a hatched subgrade.

Technical drawing of a bridge cross-section showing two directions of traffic. The drawing includes dimensions for lane widths (3.00m, 2.00m, 5.00m), elevation points (+0.00, +0.15), and a central median area with four grey rectangular structures. The road is labeled "Viale Consiglio D'Europa" and "B" at both ends.

Scala 1:100

3.00 5.00

+ 0.15

sede stradale + 0.00

Attraversamento Pedonale

Isola Salvagente + 0.15

Palina per segnaletica verticale

Viale Consiglio D'Europa

sede stradale + 0.00