

COMUNE DI SANTA MARIA CAPUA VETERE (CE)
ISTITUTO COMPRENSIVO "CARLO GALLOZZI" - SCUOLA SECONDARIA DI I GRADO - VIALE J.F.KENNEDY

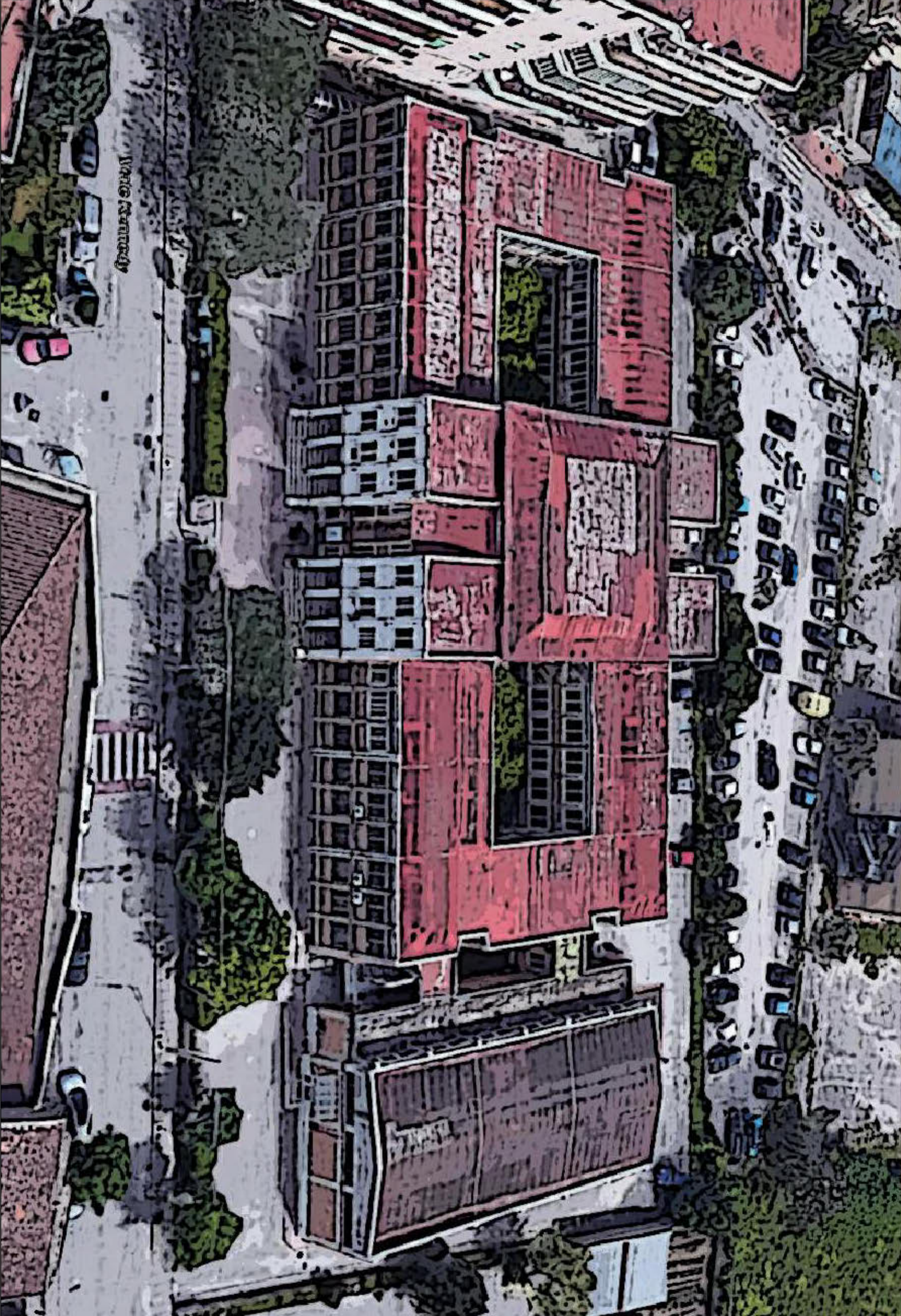

PROGETTISTA: ARCH. SEBASTIANO NARDIELLO

PROGETTO DI FATTIBILITÀ TECNICA ED ECONOMICA PER L'ADDEQUAMENTO SISMICO DELL'ISTITUTO SCOLASTICO "CARLO GALLOZZI"



COMUNE DI SANTA MARIA CAPUA VETERE (CE)
ISTITUTO COMPRENSIVO "CARLO GALLOZZI" - SCUOLA SECONDARIA DI I GRADO - VIALE J.F.KENNEDY



PROGETTISTA: ARCH. SEBASTIANO NARDIELLO

TAVOLA: IMMAGINE SATELLITARE TRIDIMENSIONALE

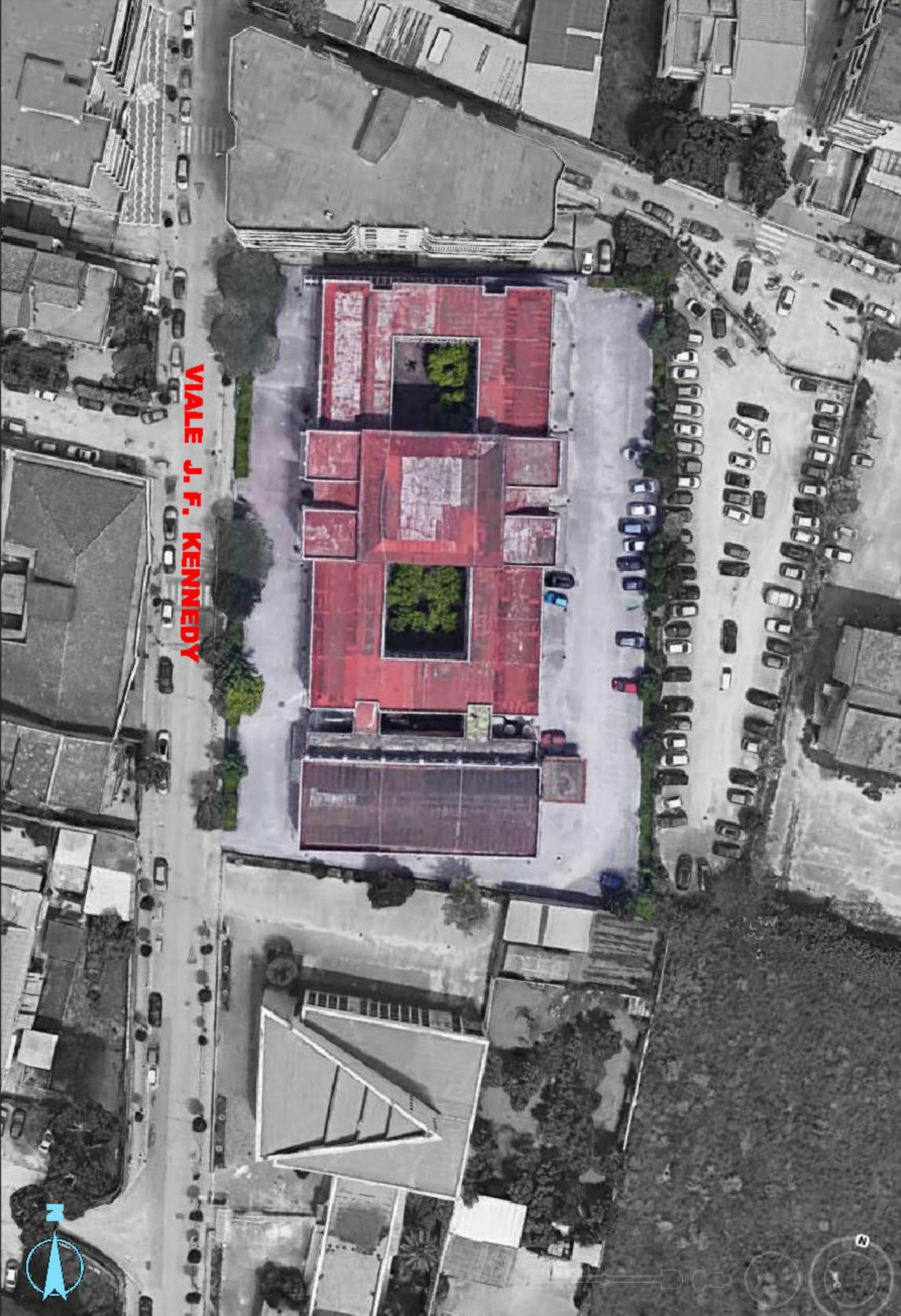

VIALE J.F. KENNEDY

TAVOLA: AREA DI INTERVENTO

PROGETTISTA: ARCH. SERGIANO NARDIELLO



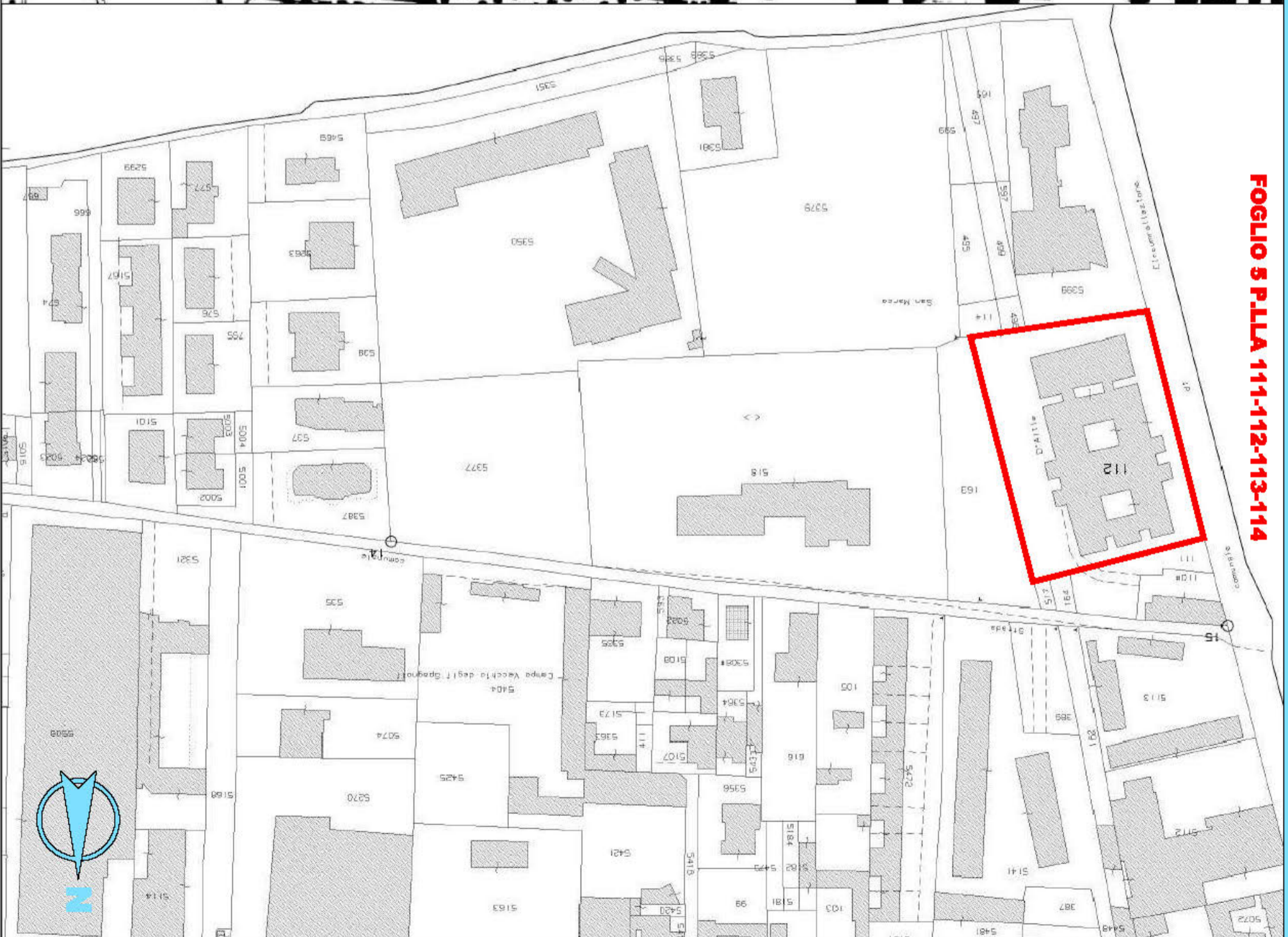

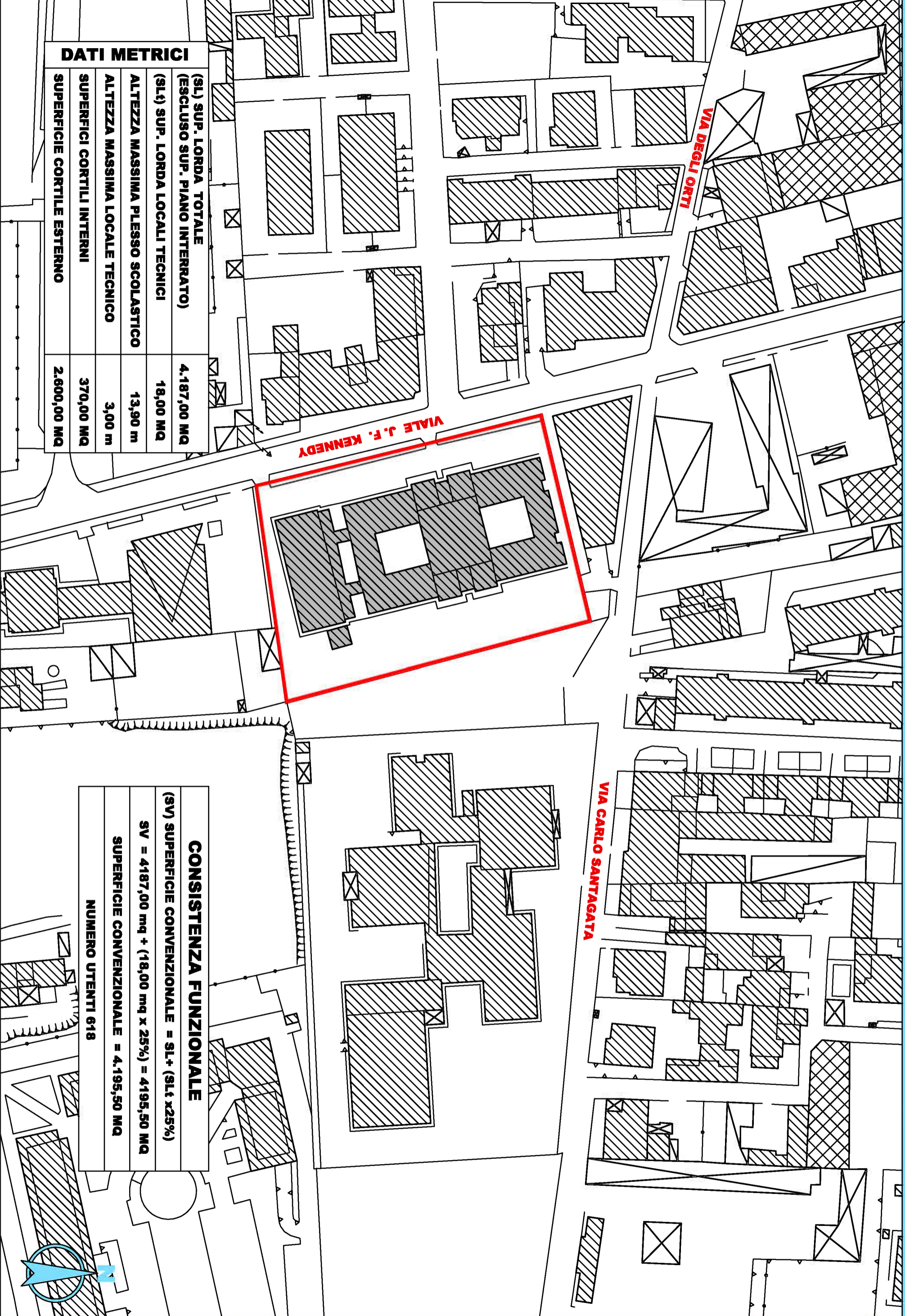

DATI METRICI

(SL) SUP. LORDA TOTALE (ESCLUSO SUP. PIANO INTERRATO)	4.187,00 MQ
(SL±) SUP. LORDA LOCALI TECNICI	18,00 MQ
ALTEZZA MASSIMA PLESSO SCOLASTICO	13,90 m
ALTEZZA MASSIMA LOCALE TECNICO	3,00 m
SUPERFICIE CORTILI INTERNI	370,00 MQ
SUPERFICIE CORTILE ESTERNO	2.600,00 MQ

CONSISTENZA FUNZIONALE

(SV) SUPERFICIE CONVENZIONALE = SL+ (SL± x25%)	
SV = 4187,00 mq + (18,00 mq x 25%) = 4195,50 MQ	
SUPERFICIE CONVENZIONALE = 4.195,50 MQ	
NUMERO UTENTI 618	

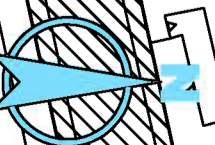

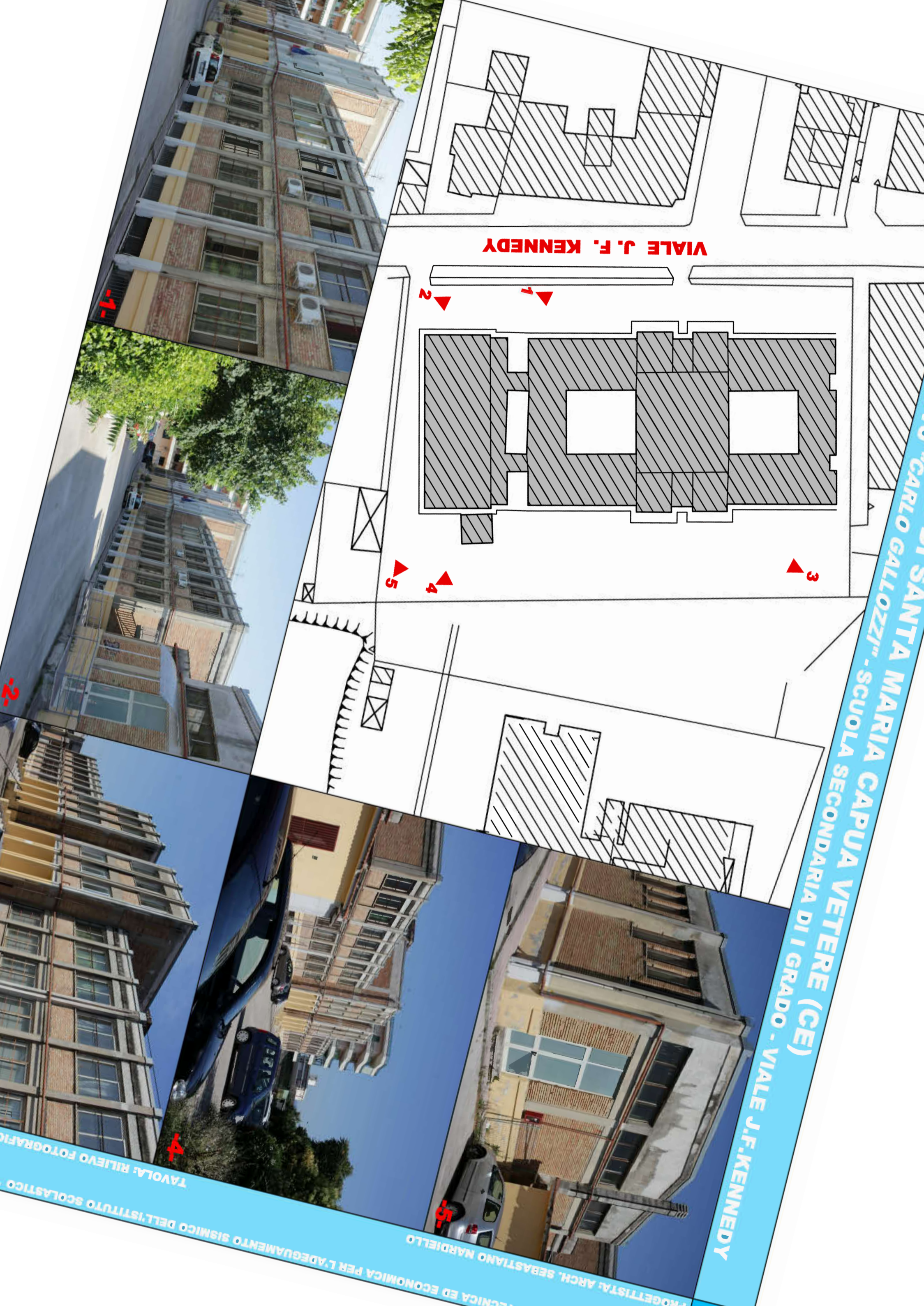

VIALE J. F. KENNEDY

DI SANTA MARIA CAPUA VETERE (CE)
"CARLO GALLOZZI" - SCUOLA SECONDARIA DI I GRADO - VIALE J.F.KENNEDY

PROGETTISTA: ARCH. SEBASTIANO NARDIELLO
TECNICA ED ECONOMICA PER L'ADEGUAMENTO SISMICO DELL'ISTITUTO SCOLASTICO

TAVOLA: RILIEVO FOTOGRAFICO

1

2

1











3

5

4









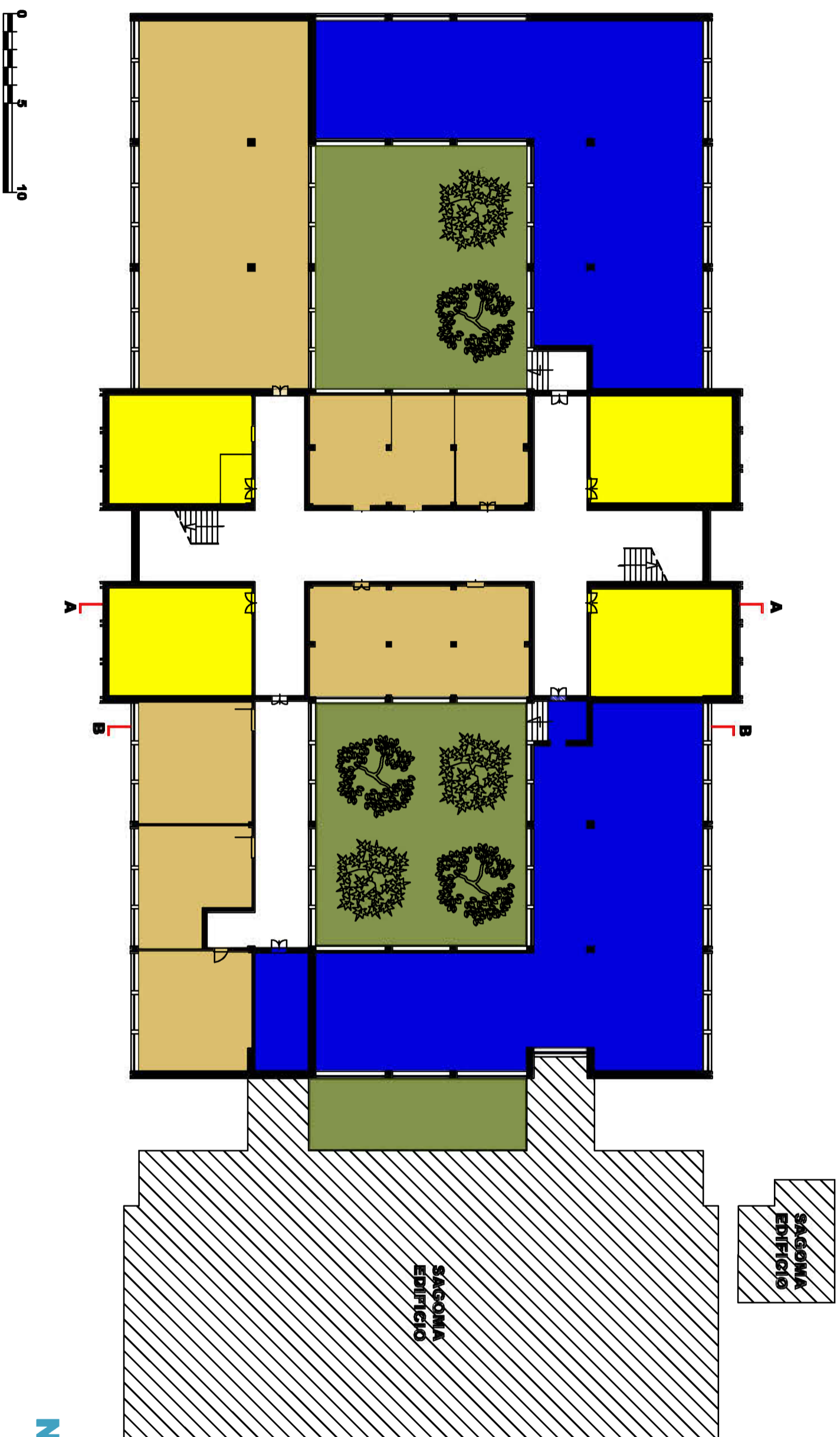

4

5

LEGENDA	
	UFFICI AMMINISTRATIVI
	AULE DIDATTICHE
	CORRIDOI, ATRI E SCALE
	SERVIZI IGIENICI
	ACCESSORI
	PALESTRA
	CORTILE SCOPERTO
	LOCALE TECNICO
	LABORATORI
	ARCHIVI









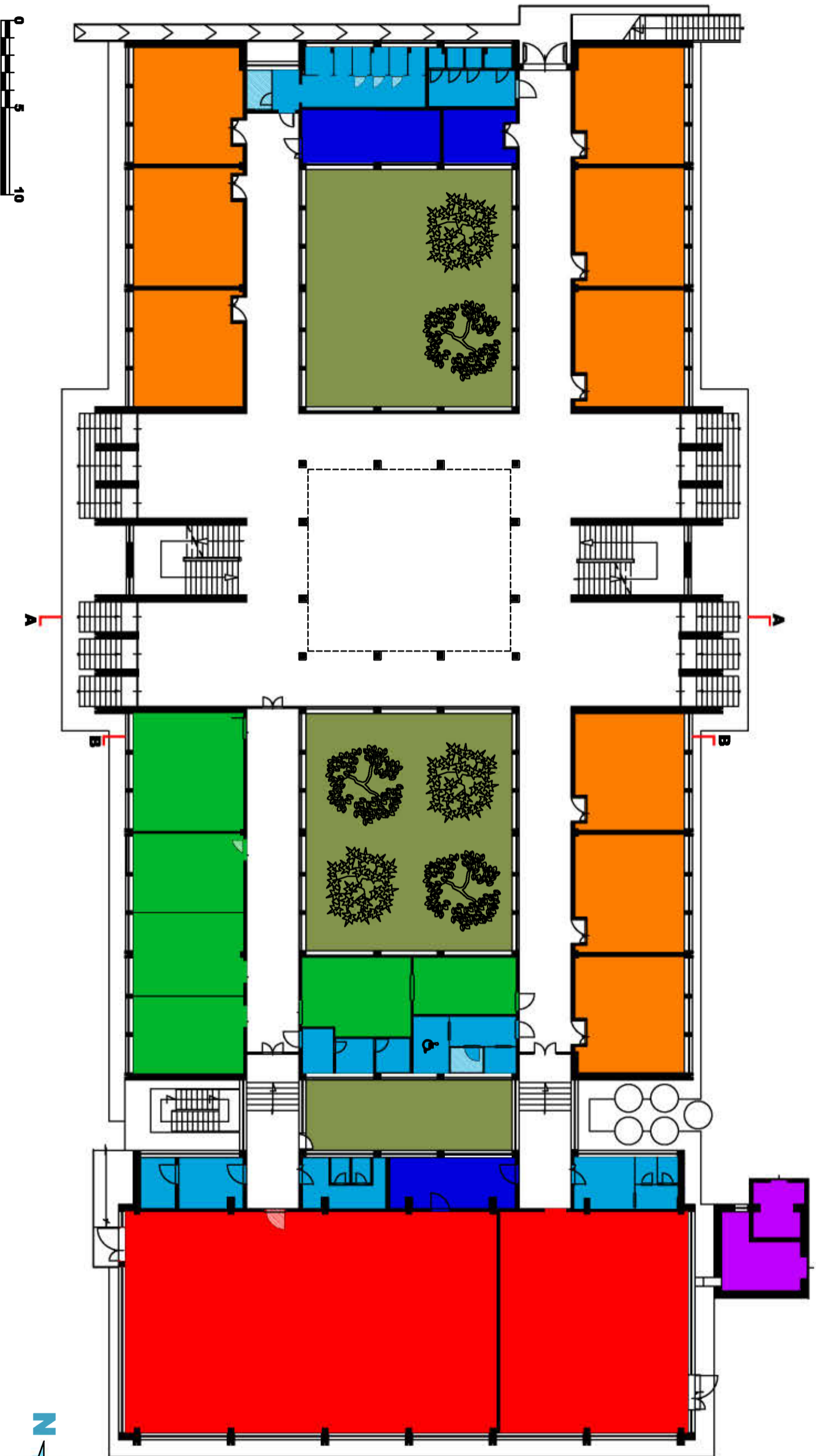

DATI METRICI	
SUP. LORDA PIANO SEMINTERRATO	1.660,00 MQ
SUP. CORTILI INTERNI	370,00 MQ
ALTEZZA NETTA INTERNA	2,67 m



LEGENDA	
	UFFICI AMMINISTRATIVI
	AULE DIDATTICHE
	CORRIDOI, ATRI E SCALE
	SERVIZI IGIENICI
	ACCESSORI
	PALESTRA
	CORTILE SCOPERTO
	LOCALE TECNICO
	LABORATORI
	ARCHIVI









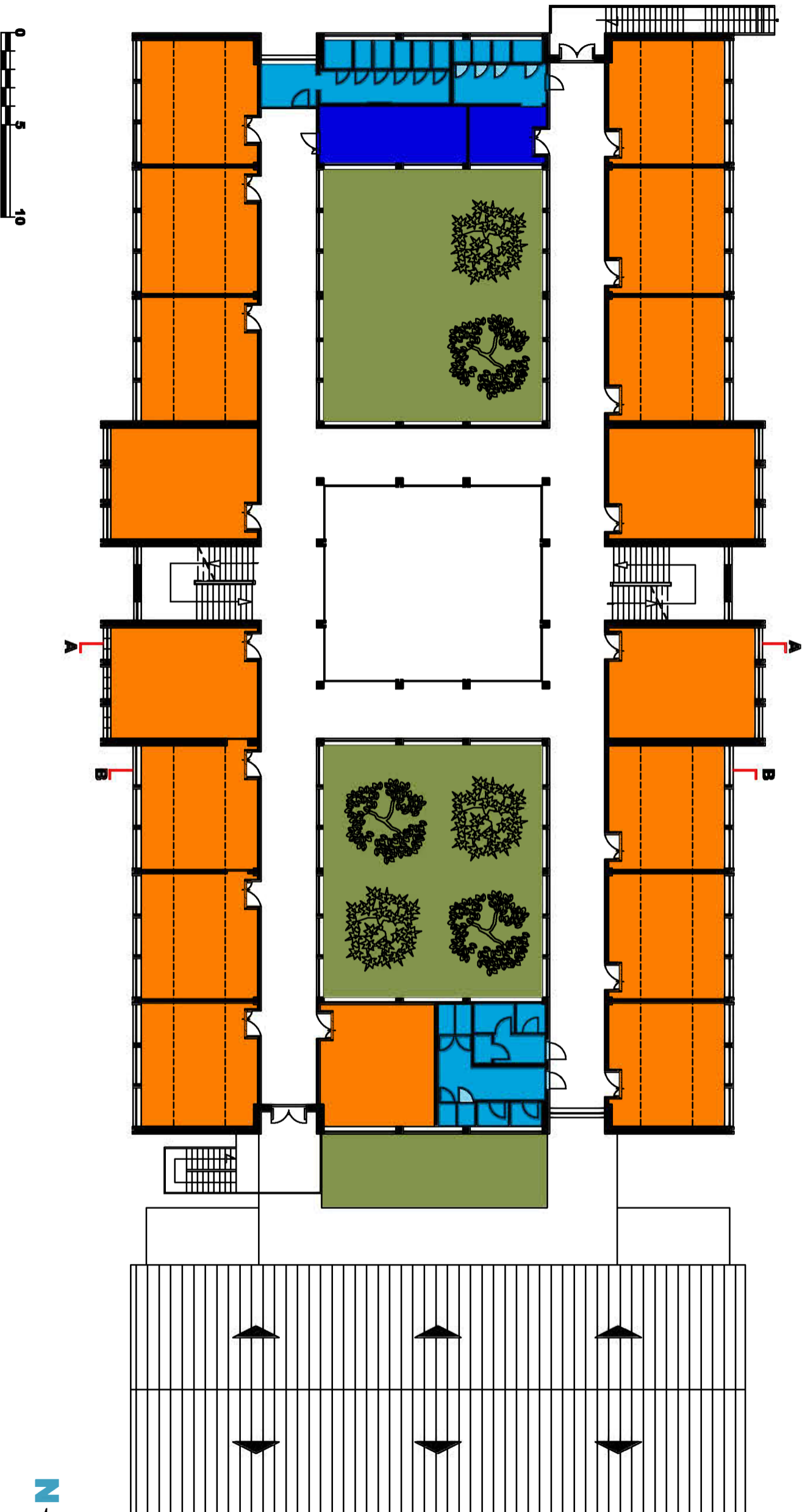

DATI METRICI	
SUP. LORDA PIANO TERRA	2.172,00 MQ
SUP. CORTILI INTERNI	370,00 MQ
SUP. CORTILE ESTERNO	2.600,00 MQ
SUP. LORDA LOCALE TECNICO	18,00 MQ
ALTEZZA NETTA INTERNA PIANO TERRA	3,17 m
ALTEZZA NETTA ATRIO	12,15 m
ALTEZZA MASSIMA PALESTRA	7,50 m



LEGENDA	
	UFFICI AMMINISTRATIVI
	AULE DIDATTICHE
	CORRIDOI, ATRI E SCALE
	SERVIZI IGIENICI
	ACCESSORI
	PALESTRA
	CORTILE SCOPERTO
	LOCALE TECNICO
	LABORATORI
	ARCHIVI

DATI METRICI	
SUP. LORDA PIANO PRIMO	1.525,00 MQ
SUP. CORTILI INTERNI	370,00 MQ
ALTEZZA NETTA PIANO PRIMO	3,18 m
ALTEZZA NETTA ATRIO	12,15 m
ALTEZZA NETTA AULE	HMin= 3,05 m
ALTEZZA NETTA AULE	HMax= 3,95 m







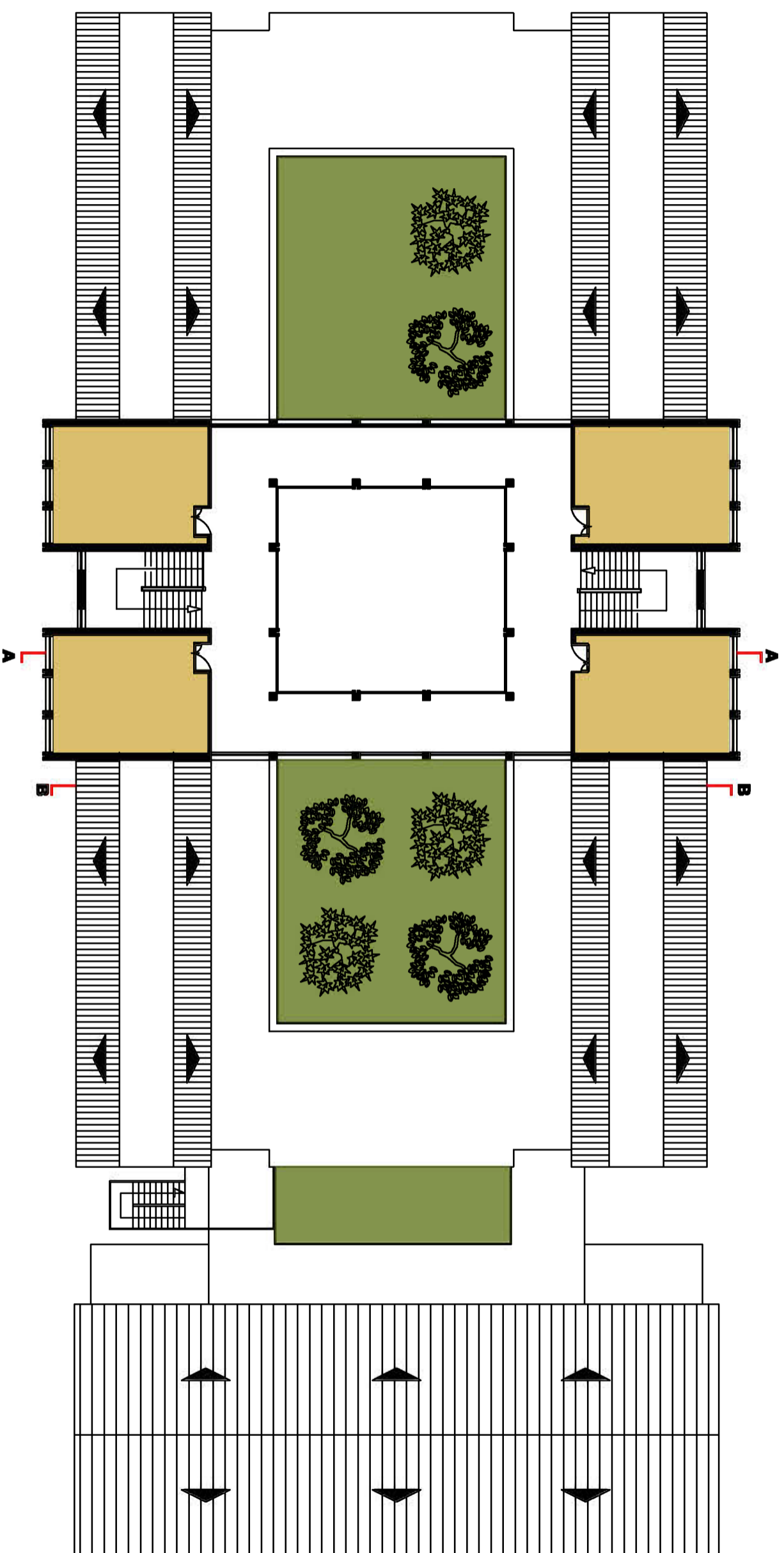

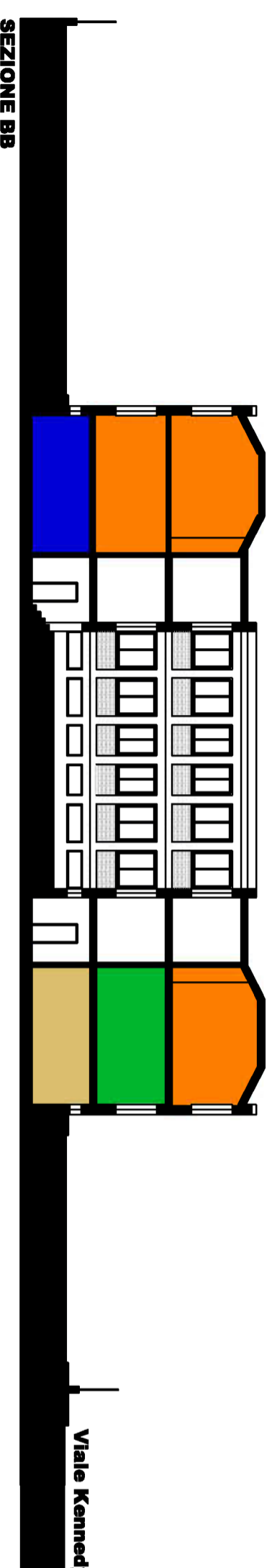
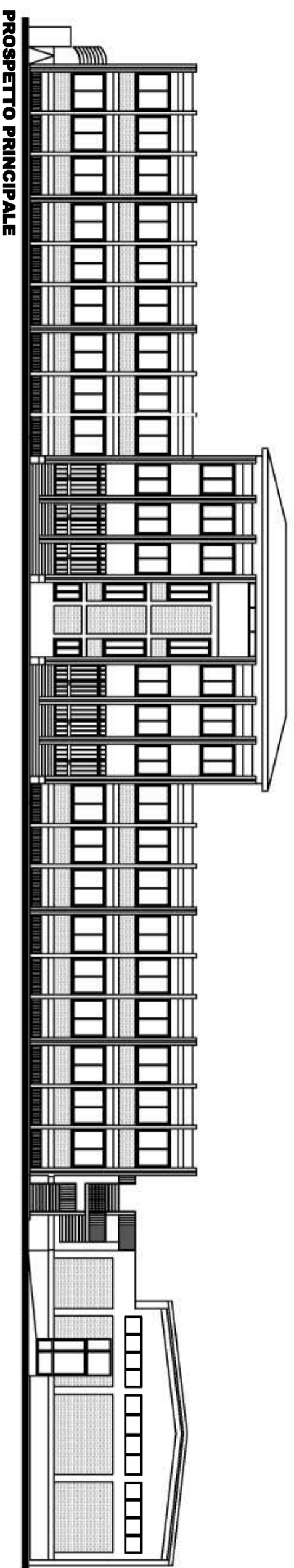

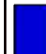

LEGENDA	
	UFFICI AMMINISTRATIVI
	AULE DIDATTICHE
	CORRIDOI, ATRI E SCALE
	SERVIZI IGIENICI
	ACCESSORI
	PALESTRA
	CORTILE SCOPERTO
	LOCALE TECNICO
	LABORATORI
	ARCHIVI

DATI METRICI	
SUP. LORDA PIANO SECONDO	490,00 MQ
SUP. CORTILI INTERNI	370,00 MQ
ALTEZZA NETTA AULE	3,20 m
ALTEZZA NETTA CORRIDOIO	HMin= 4,23 m
ALTEZZA NETTA CORRIDOIO	HMax= 5,20 m
ALTEZZA NETTA ATRIO	12,15 m





LEGENDA	
	UFFICI AMMINISTRATIVI
	AULE DIDATTICHE
	CORRIDOI, ATRI E SCALE
	SERVIZI IGIENICI
	ACCESSORI
	PALESTRA
	CORTILE SCOPERTO
	LOCALE TECNICO
	LABORATORI
	ARCHIVI





IMMAGINE SATELLITARE

PIANTA PIANO RIALZATO
Impianto strutturale primario - pilastri
 SCALA 1:300

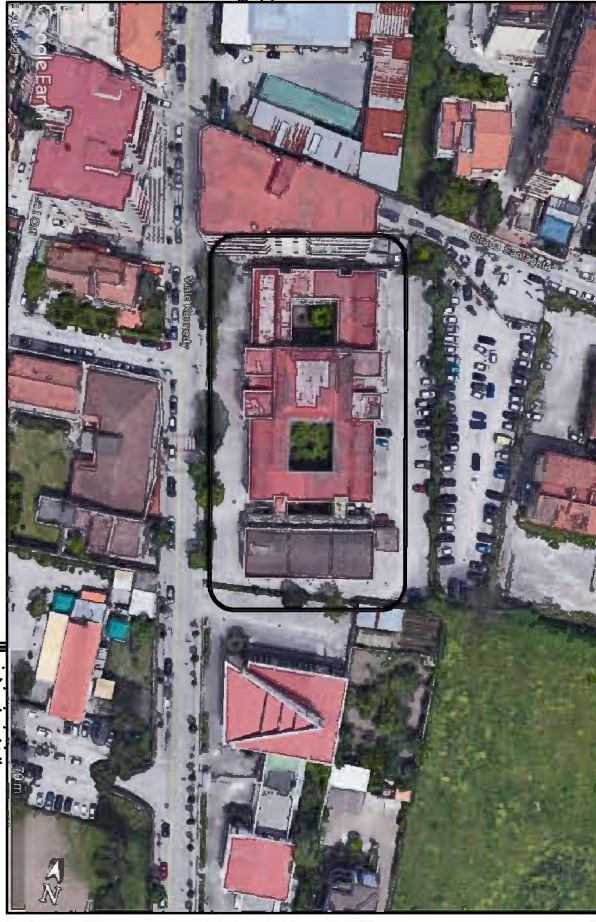
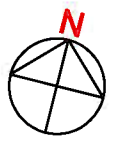
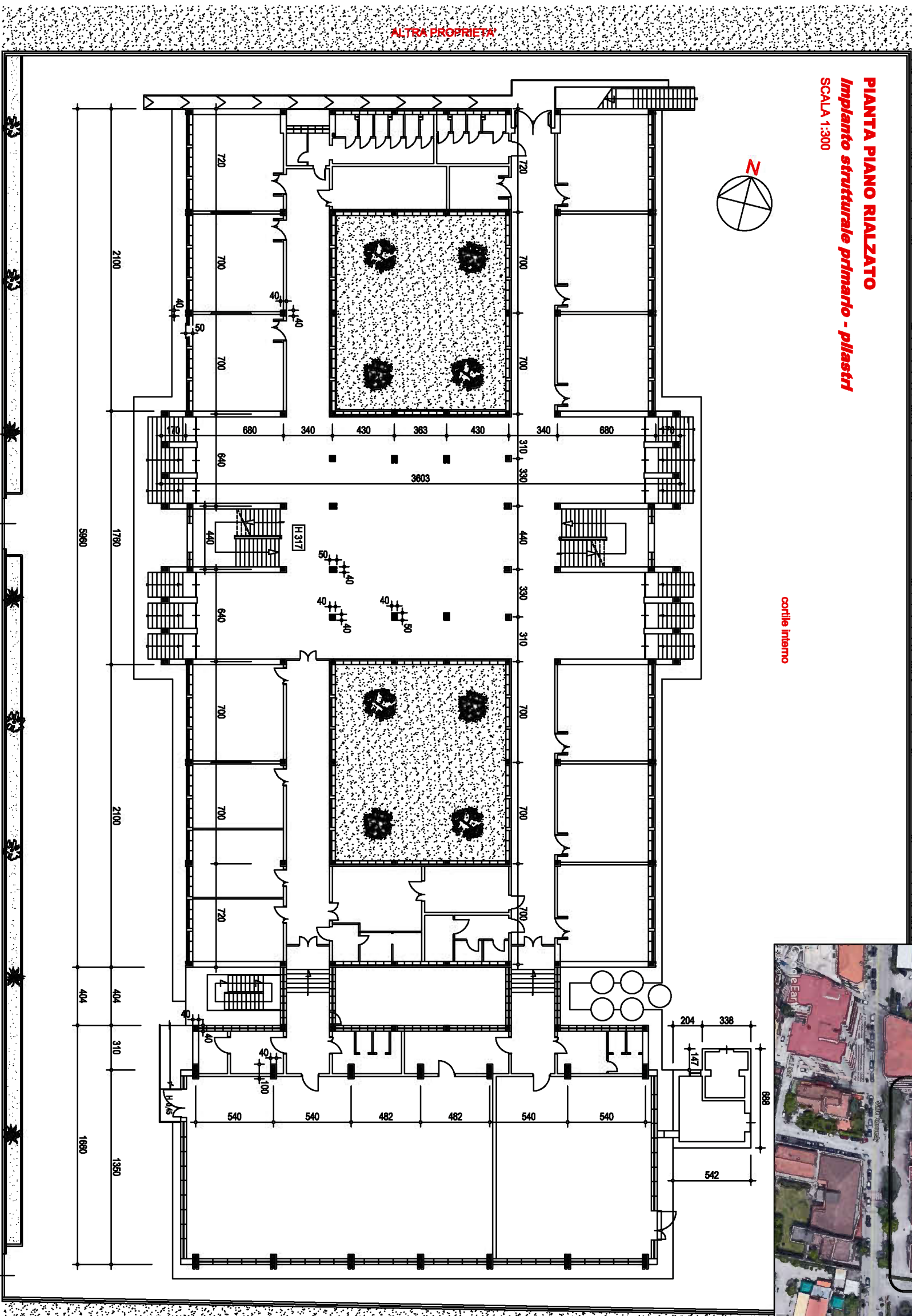

Cortile interno

CARATTERISTICHE TIPOLOGICHE PRINCIPALI	
TIPOLOGIA EDIFICIO	struttura a telaio in c.a.
N. PIANI (livelli funzionali)	2 + interrato + soffitta
CONSISTENZA FUNZIONALE	
Su (Superficie Tot. Convenzionale) [mq]	4198
N. UTENTI (studenti+docenti+non docenti)	618

PIANTA PIANO PRIMO
impianto strutturale primario - pilastri
 SCALA 1:300

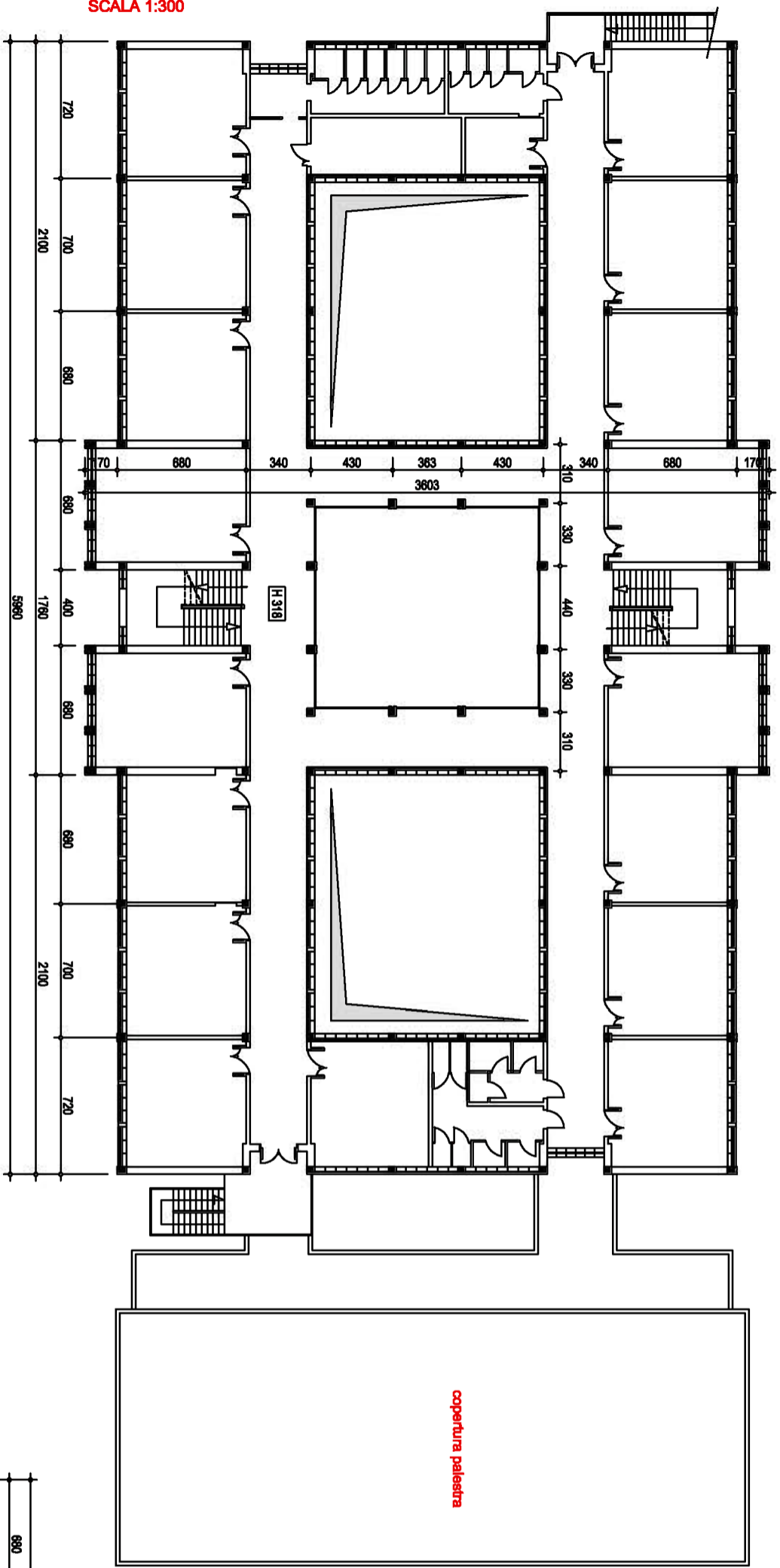

PIANTA PIANO SECONDO
impianto strutturale primario - pilastri
 SCALA 1:300

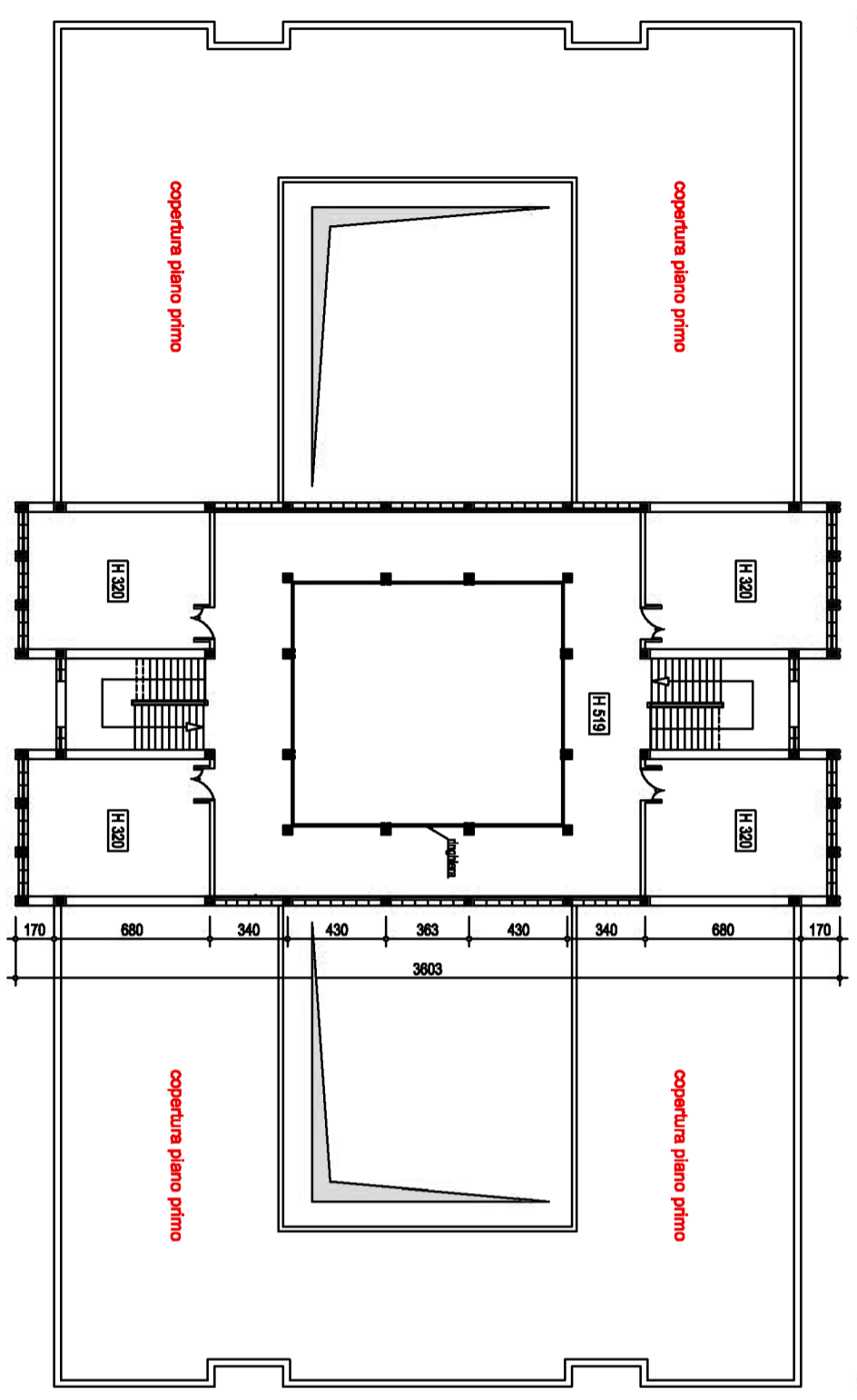

PIANTA COPERTURA
 SCALA 1:300

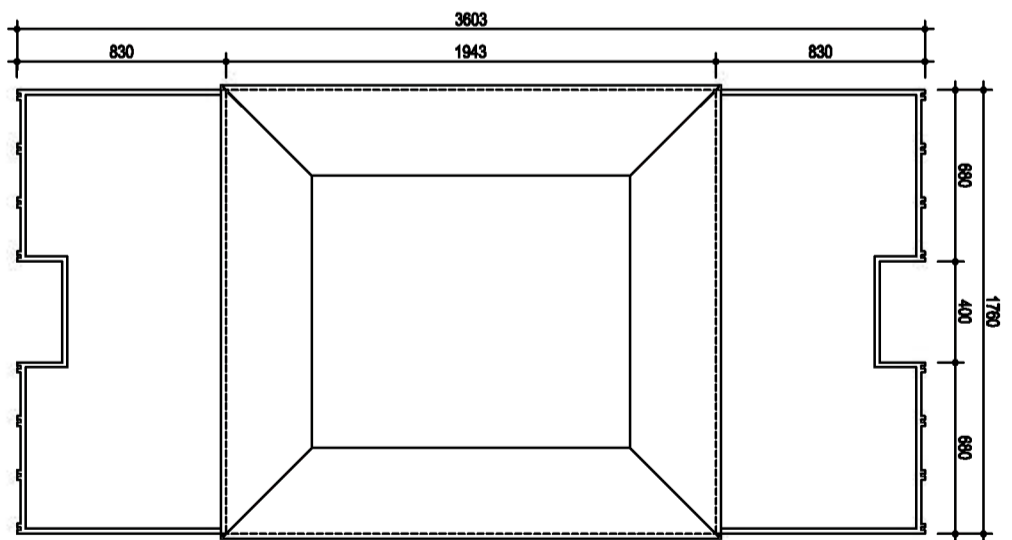

CARATTERISTICHE TIPOLOGICHE PRINCIPALI	
TIPOLOGIA EDIFICIO	struttura a telaio in c.a.
N. PIANI (livelli funzionali)	2 + interrato + soffitta
CONSISTENZA FUNZIONALE	
Su (Superficie Tot. Convenzionale) [mq]	4196
N. UTENTI (studenti+docenti+non docenti)	618

TABELLA PARAMETRI DI VALUTAZIONE (criteri relativi alla tipologia di intervento - P1)	
STRUTTURE VERTICALI	telaio in due direzioni
PILASTRI CORTI	si
IRREGOLARITA' TOMPAGNI	no
IRREGOLARITA' DI FORMA	si
INDICE TIPOLOGICO	0,70
INDICE DI DENSITA'	0,85
INDICE DI DISTRIBUZIONE	0,75

INDICE DI RISCHIO [I _r]	0,389
RISCHIO EDIFICIO [R]	0,517
PUNTEGGIO [P1]	36,972

INDICE DI RISCHIO - ALLEGATO "A"

Coordinate geografiche (WGS84)	lat.	41.0800	latitudine
	lon.	14.2641	longitudine
Coordinate geografiche (ED50)	lat.	41.0809	latitudine
	lon.	14.2650	longitudine
Classificazione della struttura	V _N	50	vita nominale
	Cl _U	III	classe d'uso
	C _U	1.5	coefficiente d'uso
	V _R	75	periodo di riferimento
	T _R	712	periodo di ritorno
Caratterizzazione sismica del sito (SLV)	a _{g,d}	0.137	accelerazione attesa su suolo rigido
	F ₀	2.564	fattore di amplificazione spettrale su suolo rigido
	T* _C	0.436	valore di riferimento per la determinazione dello spettro
	Cat. suolo	B	categoria di sottosuolo
	S _{s,d}	1.20	coefficiente di amplificazione stratigrafica
	Cat. topo	T1	categoria topografica
	S _r	1.00	coefficiente di amplificazione topografica
	S _d	1.20	coefficiente di sottosuolo
	a _{g,d} · S _d	0.164	domanda sismica (SLV)

SCHEDA DI VALUTAZIONE - CRITERI RELATIVI ALLA TIPOLOGIA DI INTERVENTO

I _R	0.389	indice di rischio
I _V = 1 - I _R	0.611	indice di vulnerabilità
I _S	0.70	indice tipologico (→ scuola secondaria I grado)
N _U	618	numero utenti (studenti + docenti + non docenti)
S _{tot} [mq]	4196	superficie totale convenzionale
I _D	0.85	indice di densità
I _L	0.75	indice di distribuzione verticale (→ n.2 piani utilizzati)
I _E = I _S · I _D · I _L	0.446	indice di esposizione
a _{g,d} · S _d	0.164	domanda sismica (SLV)
I _P = a _{g,d} · S _d / 0.35	0.470	indice di pericolosità del sito
Rischio edificio scolastico [R]	0.517	R = (I _V · 0.4) + (I _E · 0.4) + (I _P · 0.2)
Punteggio [P1]	36.972	variabilità : 0 ≤ P1 ≤ 70

Valutazione speditiva della capacità della struttura (SLV)	Str _{vert}	telai in due direzioni	
	a _{g,c} · S _c (°)	0.10	g
	Coefficienti correttivi		
	Pilastri corti	si	0.80
	Irregolarità tamponature	no	1.00
	Irregolarità di forma	si	0.80
	a _{g,c} · S _c	0.064	g

$I_R = a_{g,c} \cdot S_c / a_{g,d} \cdot S_d$